

atriadesigns.ca



premier outdoor living • solar shading • cladding products

(604) 428 1818
sales@atriadesigns.ca

S T O B A C

CASABOX

Slim box awning in
an elegant design.



CASABOX BX2000



Square design

- Sealed box protects from the elements
- Various mounting options to the wall, below the ceiling or to the frames
- Simple and proven installation system for hanging
- Awning incline adjustable to 90° depending on installation
- Optional cover profile for brackets
- Optional wall joint profile prevents rain water entering between façade and awning
- Choice of square or round design



min. 6' 2"
max. 18' 1"*



min. 5' 3"
max. 9' 10"*

* max. 16' 5" wide x 9' 10" projection
* max. 18' 1" wide x 8' 2" projection



The wind resistance class can vary depending on version and dimension.



Technical dimensions in millimetres (1 mm = 0.03937")

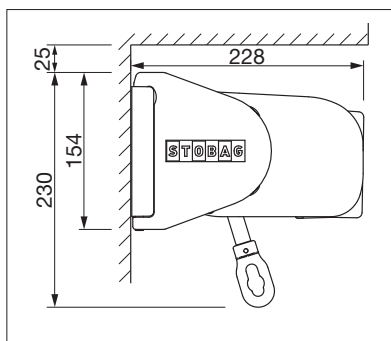

Wall installation, square design

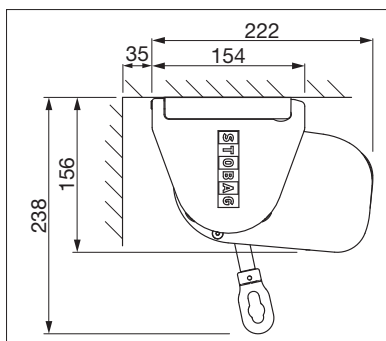

Top installation, round design



REGISTRATION
REQUIRED



COLORS

Discover the diverse options when selecting frame colors.



FABRICS

Choose from a comprehensive range of materials and colors.



ELECTRICS

More convenience thanks to the automated control.